

Vertical type connection terminal for surface mounting [AHS series] (10pcs/pack)

- This is used for fitting a PC board vertically to a surface mounting board.
- The pins on the both sides are positioning pins.
(As the positioning pins are electrically coupled, they can carry out circuit joining in the same manner as SMT pins.)
- Pitch: 2.54 mm, 1.27 mm
- Material Resin part: PPS black (UL94V-0)
Pin part: Phosphor bronze
- Finish: Gold plating over nickel base
- Rated current: 3A
- Insulation resistance: 500MΩ or over
- Withstand voltage: 500V AC, DC per minute (AH-1-1)
1000V AC, DC per minute (AH-3-1)
- Operating temperature range: -40 to +125°C

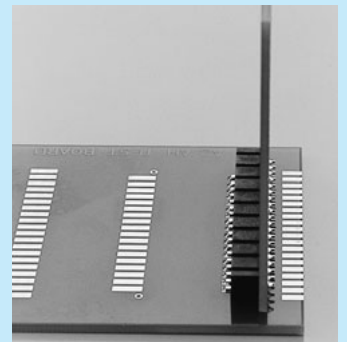

Example of usage



Part number

Part number	A	B	C	P	Maximum number of pins connected
AHS-1-1	1.27	0.7	52.07	1.27	40
AHS-3-1	1.27	1.0	50.8	2.54	20

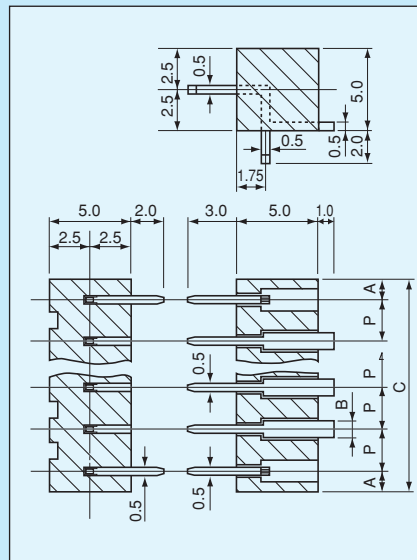

How to order

AHS-1-1-10P

Please fill in the desired number of poles.
(Please fill in the number of poles including the positioning pin.)
(With 8P as the pins for face mounting and 2P as the positioning pins)

Recommended land diameter

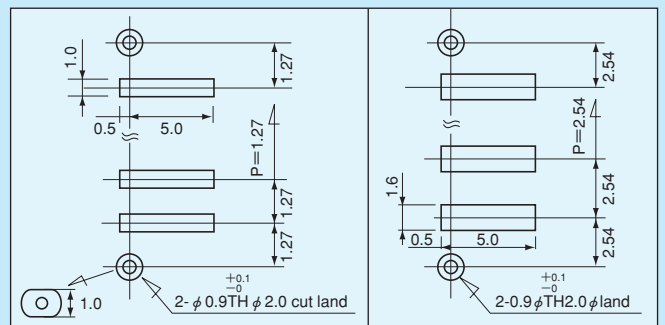

AHS-1-1

AHS-3-1

* We can manufacture the product without positioning pins.
(Please contact us.)

Instructions for mounting

In the case that a warpage occurs on the resin part during reflow because many pins are connected for use, apply an adhesive to several positions.

Instructions for use

When fitting a large board or heavy board, please use the fitting bracket AX series on the both sides.

Recommended land diameter (insertion side)

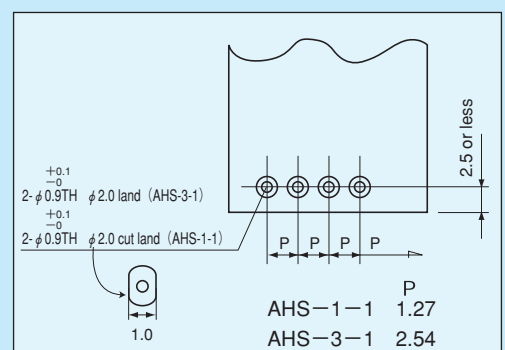

For surface mounting