

**Terminal for adjustment part [AT series] (1000pcs/pack)**

- Please use this for attaching an adjustment part such as capacitor and resistor.
- Material: Brass
- Finish: Gold plating over nickel base

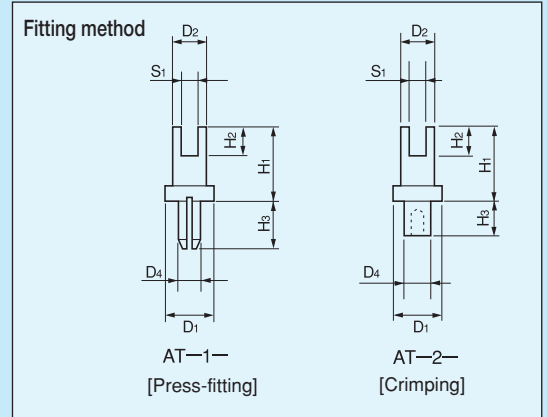
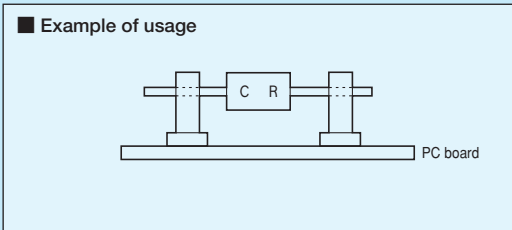

**Table of dimensions**

Part number	D <sub>1</sub>	D <sub>2</sub>	S <sub>1</sub>	D <sub>4</sub>	H <sub>1</sub>	H <sub>2</sub>	H <sub>3</sub>	Printed board fitting hole diameter	Press-fitting tool edge chip
AT-1-1	3.0	2.2	S <sub>1</sub> =1.0	1.62	5.0	2.0	3.0	1.6 φ	P-7
AT-1-2	4.0	3.0	S <sub>1</sub> =1.5	2.02	5.0	2.0	3.0	2.0	P-8
AT-1-3	3.0	2.2	S <sub>1</sub> =1.0	1.62	8.0	3.0	3.0	1.6	P-7
AT-1-4	4.0	3.0	S <sub>1</sub> =1.5	2.02	8.0	3.0	3.0	2.0	P-8
AT-1-5	4.0	3.0	S <sub>1</sub> =1.5	2.02	10.0	2.0	3.0	2.0	
AT-2-1	3.0	2.2	S <sub>1</sub> =1.0	1.7	5.0	2.0	2.5	1.8	
AT-2-2	4.0	3.0	S <sub>1</sub> =1.5	1.9	5.0	2.0	2.5	2.0	
AT-2-3	3.0	2.2	S <sub>1</sub> =1.0	1.7	8.0	3.0	2.5	1.8	
AT-2-4	4.0	3.0	S <sub>1</sub> =1.5	2.02	8.0	3.0	2.5	2.1	
AT-2-5	4.0	3.0	S <sub>1</sub> =1.5	2.02	10.0	2.0	2.5	2.1	

\* Without the press-fitting tool, you can insert the terminal by pushing it with your finger.

**Terminal for small adjustment part [KS, KB series] (1000pcs/pack)**

- Please use this for attaching an adjustment part such as capacitor and resistor of the high density mounting board.
- The printed board fitting hole diameter is φ 1.0 and φ 0.8
- Material: Brass
- Finish: Gold plating over nickel base

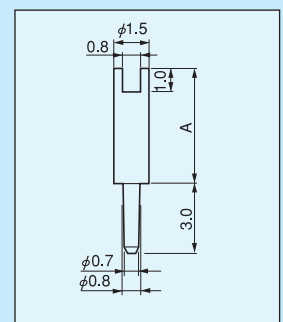
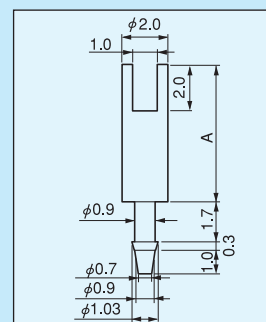
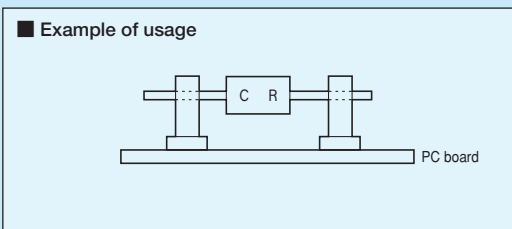

KS type (for fitting hole diameter of φ 1.0)

KB type (for fitting hole diameter of φ 0.8)

Part number	Dimension A	Printed board fitting hole diameter (φ)	Press-fitting tool edge chip
KS-1-1	6.0	1.0	P-6
KS-1-2	10.0	1.0	
KS-1-3	15.0	1.0	
KS-1-4	20.0	1.0	
KB-1-1	5.0	0.8	
KB-1-2	8.0	0.8	

\* Without the press-fitting tool, you can insert the terminal by pushing it with your finger.

\* The press-fitting tool edge chip, P series, is not operable without the main unit, PCX-1

For adjustment part