

Power supply line [PL series] (100pcs/pack)

- Please use this product when it is impossible to take the power supply pattern thickly on a high-density mounting board, etc. or when it is impossible to pass the power supply patterns.
- Material: Copper
- Exterior material: Epoxy resin blue (UL94V-0)
- Finish: Tin plating over nickel base
- Rated current: 15A
- Withstand voltage: 1000V AC, DC
- Operating temperature range: -40 to +120°C
- Printed board fitting hole diameter: ϕ 0.6 to ϕ 0.8

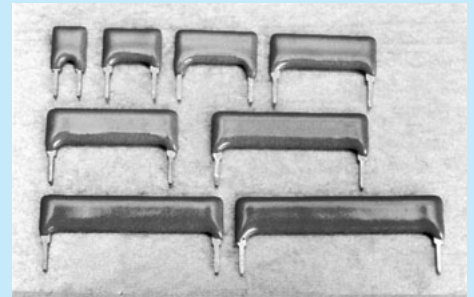

Dimension

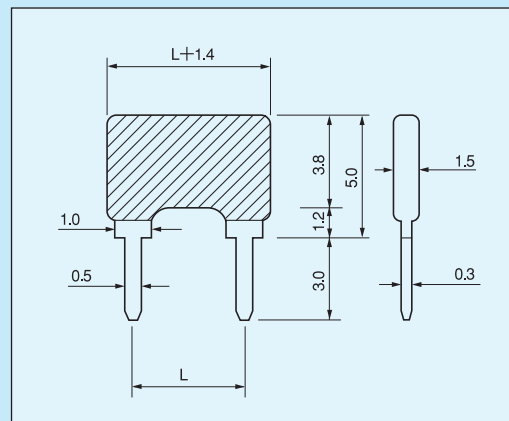

Part number	L (mm)
PL-0.1	2.54
PL-0.2	5.08
PL-0.3	7.62
PL-0.4	10.16
PL-0.5	12.7
PL-0.6	15.24
PL-0.7	17.78
PL-0.8	20.32

Jumper

Three-circuit short pin [Part number: 3JX-1] (100pcs/pack)

- By inserting to PD or PM series (socket pin), a concurrent short of three circuits is available.
- Material Resin part: PBT green (UL94V-0)
Pin part: Phosphor bronze
- Finish Pin part: Gold plating over nickel base

■ Part number.....3JX-1

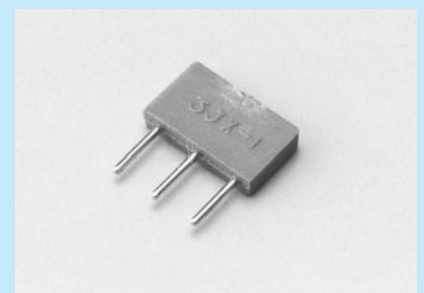

Example of usage

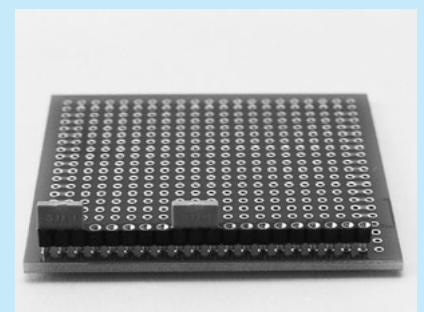
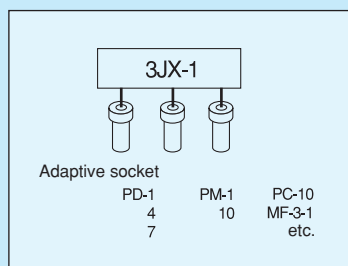
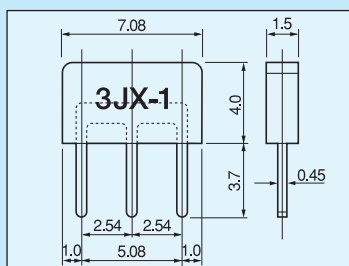

Combination of 3JX-1 and PM-1