

Through hole tap

TH-0.8 series

- A chip mounter can be used for this spacer.
- A spacer can be fit on a PC board just by automatically loading it on the PC board and carrying out reflow.
- It can be fit from the part face, soldering face and the both sides.
- Tape-and-reel has an adsorption film. Please remove by pushing it from the opposite side after reflow.
- The jig for removing adsorption films (Part No.: TH-JIG) is available.
- Material: Brass
- Finish: Tin plating over nickel base
- Rated current:
 - TH-0.8- □ -M2.5.....20A
 - TH-0.8- □ -M2.6.....20A
 - TH-0.8- □ -M330A
 - TH-0.8- □ -M440A
- Tightening torque:
 - TH-0.8- □ -M2.5.....3kgf-cm (29.4N-cm) or less
 - TH-0.8- □ -M2.6.....3kgf-cm (29.4N-cm) or less
 - TH-0.8- □ -M3.....5kgf-cm (49N-cm) or less (X-direction)
3kgf-cm (29.4N-cm) or less (Y-direction)
 - TH-0.8- □ -M4.....8kgf-cm (78.4N-cm) or less
- Adaptive printed board thickness: t0.8 or over
(There is no problem if it is used for other board thickness.)
- Please use the automatic mounter of automatic recognition type.

Dimension

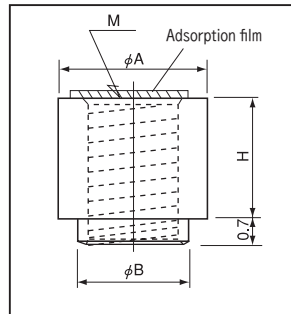

Condition of fitting to the PC board

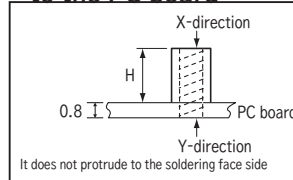

Example of usage

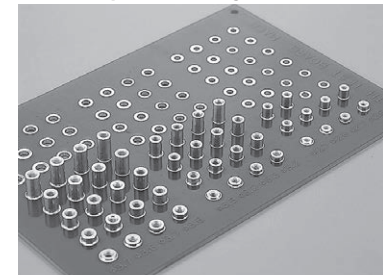

With the adsorption film removed after reflow



Condition of fitting the panel to the printed board

Part No.

Part No.	A	B	H	M	quantity per reel
TH-0.8-1.0-M2.5	4.5	3.1	1.0	M2.5	450 pcs
TH-0.8-1.5-M2.5	4.5	3.1	1.5	M2.5	450 pcs
TH-0.8-2.0-M2.5	4.5	3.1	2.0	M2.5	450 pcs
TH-0.8-2.5-M2.5	4.5	3.1	2.5	M2.5	350 pcs
TH-0.8-3.0-M2.5	4.5	3.1	3.0	M2.5	350 pcs
TH-0.8-3.5-M2.5	4.5	3.1	3.5	M2.5	350 pcs
TH-0.8-4.0-M2.5	4.5	3.1	4.0	M2.5	250 pcs
TH-0.8-4.5-M2.5	4.5	3.1	4.5	M2.5	250 pcs
TH-0.8-5.0-M2.5	4.5	3.1	5.0	M2.5	250 pcs
TH-0.8-5.5-M2.5	4.5	3.1	5.5	M2.5	350 pcs
TH-0.8-6.0-M2.5	4.5	3.1	6.0	M2.5	350 pcs
TH-0.8-6.5-M2.5	4.5	3.1	6.5	M2.5	300 pcs
TH-0.8-7.0-M2.5	4.5	3.1	7.0	M2.5	300 pcs
TH-0.8-7.5-M2.5	4.5	3.1	7.5	M2.5	300 pcs
TH-0.8-8.0-M2.5	4.5	3.1	8.0	M2.5	300 pcs
TH-0.8-8.5-M2.5	4.5	3.1	8.5	M2.5	250 pcs
TH-0.8-9.0-M2.5	4.5	3.1	9.0	M2.5	250 pcs
TH-0.8-9.5-M2.5	4.5	3.1	9.5	M2.5	250 pcs
TH-0.8-10-M2.5	4.5	3.1	10	M2.5	250 pcs
TH-0.8-1.0-M2.6	4.5	3.1	1.0	M2.6	450 pcs
TH-0.8-1.5-M2.6	4.5	3.1	1.5	M2.6	450 pcs
TH-0.8-2.0-M2.6	4.5	3.1	2.0	M2.6	450 pcs
TH-0.8-2.5-M2.6	4.5	3.1	2.5	M2.6	350 pcs
TH-0.8-3.0-M2.6	4.5	3.1	3.0	M2.6	350 pcs
TH-0.8-3.5-M2.6	4.5	3.1	3.5	M2.6	350 pcs
TH-0.8-4.0-M2.6	4.5	3.1	4.0	M2.6	250 pcs
TH-0.8-4.5-M2.6	4.5	3.1	4.5	M2.6	250 pcs
TH-0.8-5.0-M2.6	4.5	3.1	5.0	M2.6	250 pcs
TH-0.8-5.5-M2.6	4.5	3.1	5.5	M2.6	350 pcs
TH-0.8-6.0-M2.6	4.5	3.1	6.0	M2.6	350 pcs
TH-0.8-6.5-M2.6	4.5	3.1	6.5	M2.6	300 pcs
TH-0.8-7.0-M2.6	4.5	3.1	7.0	M2.6	300 pcs
TH-0.8-7.5-M2.6	4.5	3.1	7.5	M2.6	300 pcs
TH-0.8-8.0-M2.6	4.5	3.1	8.0	M2.6	300 pcs
TH-0.8-8.5-M2.6	4.5	3.1	8.5	M2.6	250 pcs
TH-0.8-9.0-M2.6	4.5	3.1	9.0	M2.6	250 pcs
TH-0.8-9.5-M2.6	4.5	3.1	9.5	M2.6	250 pcs
TH-0.8-10-M2.6	4.5	3.1	10	M2.6	250 pcs

Part No.	A	B	H	M	quantity per reel
TH-0.8-1.2-M3	5.0	3.5	1.2	M3	450 pcs
TH-0.8-1.5-M3	5.0	3.5	1.5	M3	450 pcs
TH-0.8-2.0-M3	5.0	3.5	2.0	M3	450 pcs
TH-0.8-2.5-M3	5.0	3.5	2.5	M3	350 pcs
TH-0.8-3.0-M3	5.0	3.5	3.0	M3	350 pcs
TH-0.8-3.5-M3	5.0	3.5	3.5	M3	350 pcs
TH-0.8-4.0-M3	5.0	3.5	4.0	M3	250 pcs
TH-0.8-4.5-M3	5.0	3.5	4.5	M3	250 pcs
TH-0.8-5.0-M3	5.0	3.5	5.0	M3	250 pcs
TH-0.8-5.5-M3	5.0	3.5	5.5	M3	350 pcs
TH-0.8-6.0-M3	5.0	3.5	6.0	M3	350 pcs
TH-0.8-6.5-M3	5.0	3.5	6.5	M3	300 pcs
TH-0.8-7.0-M3	5.0	3.5	7.0	M3	300 pcs
TH-0.8-7.5-M3	5.0	3.5	7.5	M3	300 pcs
TH-0.8-8.0-M3	5.0	3.5	8.0	M3	300 pcs
TH-0.8-8.5-M3	5.0	3.5	8.5	M3	250 pcs
TH-0.8-9.0-M3	5.0	3.5	9.0	M3	250 pcs
TH-0.8-9.5-M3	5.0	3.5	9.5	M3	250 pcs
TH-0.8-10-M3	5.0	3.5	10	M3	250 pcs
TH-0.8-2.0-M4	7.0	5.5	2.0	M4	350 pcs
TH-0.8-2.5-M4	7.0	5.5	2.5	M4	250 pcs
TH-0.8-3.0-M4	7.0	5.5	3.0	M4	250 pcs
TH-0.8-3.5-M4	7.0	5.5	3.5	M4	200 pcs
TH-0.8-4.0-M4	7.0	5.5	4.0	M4	200 pcs
TH-0.8-4.5-M4	7.0	5.5	4.5	M4	450 pcs
TH-0.8-5.0-M4	7.0	5.5	5.0	M4	450 pcs
TH-0.8-5.5-M4	7.0	5.5	5.5	M4	300 pcs
TH-0.8-6.0-M4	7.0	5.5	6.0	M4	300 pcs
TH-0.8-6.5-M4	7.0	5.5	6.5	M4	250 pcs
TH-0.8-7.0-M4	7.0	5.5	7.0	M4	250 pcs
TH-0.8-7.5-M4	7.0	5.5	7.5	M4	200 pcs
TH-0.8-8.0-M4	7.0	5.5	8.0	M4	200 pcs
TH-0.8-8.5-M4	7.0	5.5	8.5	M4	200 pcs
TH-0.8-9.0-M4	7.0	5.5	9.0	M4	200 pcs
TH-0.8-9.5-M4	7.0	5.5	9.5	M4	200 pcs
TH-0.8-10-M4	7.0	5.5	10	M4	200 pcs

- M2.5 P = 0.45
- M2.6 P = 0.45
- M3 P = 0.5
- M4 P = 0.7

▲ Use of a through hole tap is limited to a through hole board. (It is impossible to use it for a one-sided board and non through hole board.)

To order bulk product

TH-0.8-5.0-M3-B

↑ Please specify B.

- 100 pieces are included in 1 pack.
- Adsorption films are not put on the bulk products.

Through hole tap

TH-0.8 series specification

■ Recommended land information

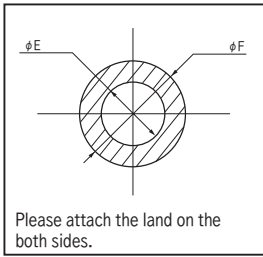

■ Recommended metal mask
(Recommended metal mask thickness: 150 μm to 200 μm)

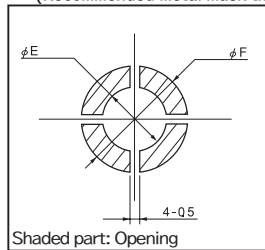

Part No.	E	F
TH-0.8-□ -M2.5	3.3	5.5
TH-0.8-□ -M2.6	3.3	5.5
TH-0.8-□ -M3	3.7	6.0
TH-0.8-□ -M4	5.7	8.0

• If it is bigger than the recommended fitting through hole (φ E), the torque to the Y-direction (soldering face side) will be decreased. (As the flow of soldering to the through hole is reduced)

■ Dimension of the reel

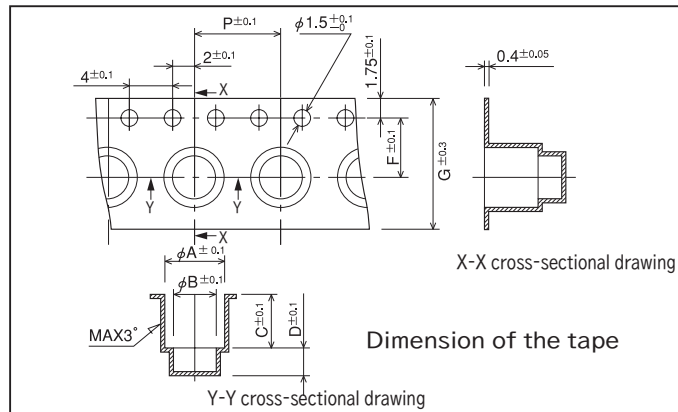
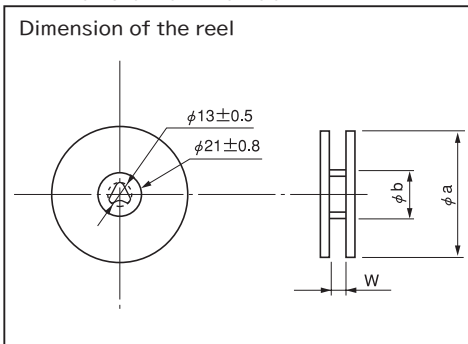

■ Part No.

Part No.	Reel			Tape						
	a	b	W	A	B	C	D	F	G	P
TH-0.8-1.0-M2.6	180	60	13	4.8	3.4	1.3	1.7	5.5	12	8
TH-0.8-1.5-M2.6	180	60	13	4.8	3.4	2.3	1.7	5.5	12	8
TH-0.8-2.0-M2.6	180	60	13	4.8	3.4	2.3	1.7	5.5	12	8
TH-0.8-2.5-M2.6	180	60	13	4.8	3.4	3.8	1.7	5.5	12	8
TH-0.8-3.0-M2.6	180	60	13	4.8	3.4	3.8	1.7	5.5	12	8
TH-0.8-3.5-M2.6	180	60	13	4.8	3.4	3.8	1.7	5.5	12	8
TH-0.8-4.0-M2.6	180	60	13	4.8	3.4	5.0	1.7	5.5	12	8
TH-0.8-4.5-M2.6	180	60	13	4.8	3.4	5.0	1.7	5.5	12	8
TH-0.8-5.0-M2.6	180	60	13	4.8	3.4	5.0	1.7	5.5	12	8
TH-0.8-5.5-M2.6	254	80	17.5	4.8	0	6.8	0	7.5	16	12
TH-0.8-6.0-M2.6	254	80	17.5	4.8	0	6.8	0	7.5	16	12
TH-0.8-6.5-M2.6	254	80	17.5	4.8	0	7.8	0	7.5	16	12
TH-0.8-7.0-M2.6	254	80	17.5	4.8	0	7.8	0	7.5	16	12
TH-0.8-7.5-M2.6	254	80	17.5	4.8	0	8.8	0	7.5	16	12
TH-0.8-8.0-M2.6	254	80	17.5	4.8	0	8.8	0	7.5	16	12
TH-0.8-8.5-M2.6	254	80	17.5	4.8	0	9.8	0	7.5	16	12
TH-0.8-9.0-M2.6	254	80	17.5	4.8	0	9.8	0	7.5	16	12
TH-0.8-9.5-M2.6	254	80	17.5	4.8	0	10.8	0	7.5	16	12
TH-0.8-10-M2.6	254	80	17.5	4.8	0	10.8	0	7.5	16	12
TH-0.8-1.2-M3	180	60	13	5.3	3.8	1.5	1.7	5.5	12	8
TH-0.8-1.5-M3	180	60	13	5.3	3.8	2.3	1.7	5.5	12	8
TH-0.8-2.0-M3	180	60	13	5.3	3.8	2.3	1.7	5.5	12	8
TH-0.8-2.5-M3	180	60	13	5.3	3.8	3.8	1.7	5.5	12	8
TH-0.8-3.0-M3	180	60	13	5.3	3.8	3.8	1.7	5.5	12	8
TH-0.8-3.5-M3	180	60	13	5.3	3.8	3.8	1.7	5.5	12	8
TH-0.8-4.0-M3	180	60	13	5.3	3.8	5.3	1.7	5.5	12	8
TH-0.8-4.5-M3	180	60	13	5.3	3.8	5.3	1.7	5.5	12	8
TH-0.8-5.0-M3	180	60	13	5.3	3.8	5.3	1.7	5.5	12	8

Part No.	Reel			Tape						
	a	b	W	A	B	C	D	F	G	P
TH-0.8-5.5-M3	254	80	17.5	5.3	0	6.8	0	7.5	16	12
TH-0.8-6.0-M3	254	80	17.5	5.3	0	6.8	0	7.5	16	12
TH-0.8-6.5-M3	254	80	17.5	5.3	0	7.8	0	7.5	16	12
TH-0.8-7.0-M3	254	80	17.5	5.3	0	7.8	0	7.5	16	12
TH-0.8-7.5-M3	254	80	17.5	5.3	0	8.8	0	7.5	16	12
TH-0.8-8.0-M3	254	80	17.5	5.3	0	8.8	0	7.5	16	12
TH-0.8-8.5-M3	254	80	17.5	5.3	0	9.8	0	7.5	16	12
TH-0.8-9.0-M3	254	80	17.5	5.3	0	9.8	0	7.5	16	12
TH-0.8-9.5-M3	254	80	17.5	5.3	0	10.8	0	7.5	16	12
TH-0.8-10-M3	254	80	17.5	5.3	0	10.8	0	7.5	16	12
TH-0.8-2.0-M4	180	80	17.5	7.3	0	3.0	0	7.5	16	12
TH-0.8-2.5-M4	180	80	17.5	7.3	0	4.0	0	7.5	16	12
TH-0.8-3.0-M4	180	80	17.5	7.3	0	4.0	0	7.5	16	12
TH-0.8-3.5-M4	180	80	17.5	7.3	0	5.0	0	7.5	16	12
TH-0.8-4.0-M4	180	80	17.5	7.3	0	5.0	0	7.5	16	12
TH-0.8-4.5-M4	254	80	17.5	7.3	0	6.0	0	7.5	16	12
TH-0.8-5.0-M4	254	80	17.5	7.3	0	6.0	0	7.5	16	12
TH-0.8-5.5-M4	254	80	25.5	7.3	0	7.0	0	11.5	24	16
TH-0.8-6.0-M4	254	80	25.5	7.3	0	7.0	0	11.5	24	16
TH-0.8-6.5-M4	254	80	25.5	7.3	0	8.0	0	11.5	24	16
TH-0.8-7.0-M4	254	80	25.5	7.3	0	8.0	0	11.5	24	16
TH-0.8-7.5-M4	254	80	25.5	7.3	0	9.0	0	11.5	24	16
TH-0.8-8.0-M4	254	80	25.5	7.3	0	9.0	0	11.5	24	16
TH-0.8-8.5-M4	254	80	25.5	7.3	0	10	0	11.5	24	16
TH-0.8-9.0-M4	254	80	25.5	7.3	0	10	0	11.5	24	16
TH-0.8-9.5-M4	254	80	25.5	7.3	0	11	0	11.5	24	16
TH-0.8-10-M4	254	80	25.5	7.3	0	11	0	11.5	24	16

• The M2.5 type is the same as the M2.6.