

For two-tiered installation of PC boards

Fixed type product [DP series] (1000pcs/pack)

- This is used for mounting PC boards by two-tiered installation.
- Both the main board and the slave board are fixed by soldering.
- Material: Brass
- Finish: DP-1, 2, 4: Gold plating over nickel base
DP-5, 10, 15, 20: Tin plating over nickel base
- Rated current: DP-1, 2, 4: 5A
DP-5, 10, 15, 20: 20A

Part number	L (mm)	Distance H (mm) between the main board and the slave board	Printed board fitting hole diameter (φ)	Fitting method	Press-fitting tool edge chip
DP-1	6.5	7.5	0.8	One-side press-fitting method	P-5
DP-2	11.0	12.0	0.8		
DP-4	3.0	4.0	0.8		
DP-5	5.0	5.0	1.6		
DP-10	10.0	10.0	1.6		
DP-15	15.0	15.0	1.6		
DP-20	20.0	20.0	1.6		

* The press-fitting tool edge chip, P series, is not operable without the main unit, PCX-1

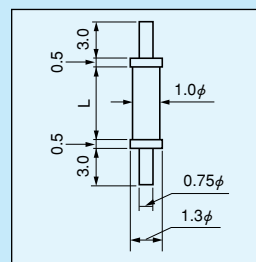
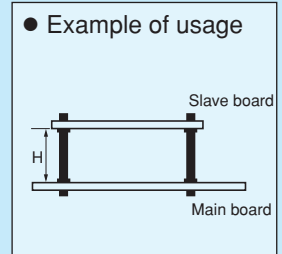

DP-1
DP-2
DP-4

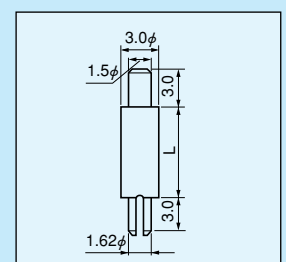

DP-5
DP-10
DP-15
DP-20

For two-tiered type

For two-tiered installation of super-small boards [DS series] (1000pcs/pack)

- This is used for mounting small boards by two-tiered installation.
- Both the main board and the slave board are fixed by soldering.
- Material: Phosphor bronze
- Finish: Gold plating over nickel base
- Rated current: 2A
- Printed board fitting hole diameter: φ 0.5

Part number	L (mm)
DS-1.5	1.5
DS-2	2
DS-2.5	2.5
DS-3	3
DS-3.5	3.5
DS-4	4
DS-4.5	4.5
DS-6	6

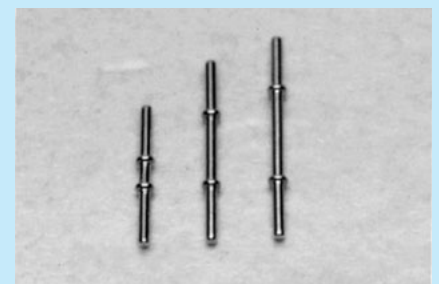

■ Dimension

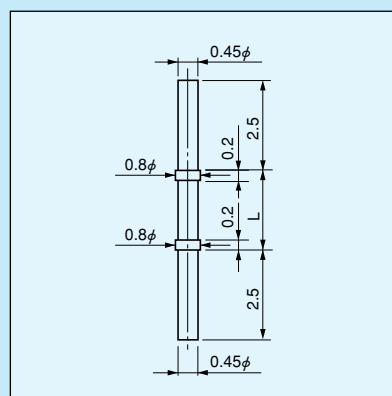

■ Example of usage

